

## TH TYPE

(1) ORDERING CODE 產品名稱

Y9D TH 2.6 x 2.4 S14 OC3 P0.35

Material Type Outside Diameter(A φ) Length(D) Shape Thread Type Thread Pitch  
 材質 形狀 外徑(A φ) 長度(D) 形體 螺紋角度 螺紋節距

(2) SUITABLE MATERIAL(適用材質)

E1C, Y5E, Y8B, Y9, Y9D, Y11...

(3) SHAPE(圖形標示)

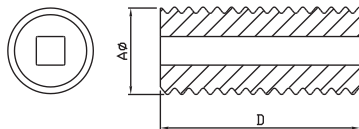

Fig 1

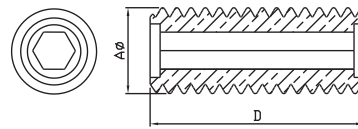

Fig 2

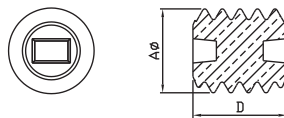

Fig 3

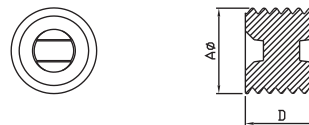

Fig 4

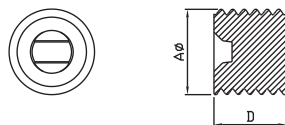
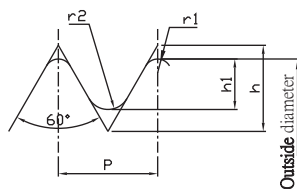
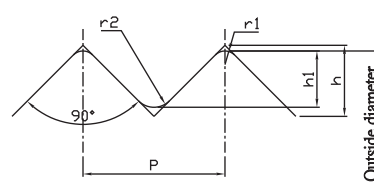

Fig 5



THREAD (OC-3)



THREAD (OC-4)

THREAD TYPE(螺紋角度)

Unit:mm

Thread	Pitch p	Depth engagement h1	Degree	Crest radius r1	Root radius r2
OC-3	0.35±0.03	0.16 <sup>+0.10</sup> <sub>-0.05</sub>	60±5	0.08+0	0.22
	0.50±0.03	0.23 <sup>+0.10</sup> <sub>-0.05</sub>	60±5	0.08+0	0.22
	0.60±0.03	0.28 <sup>+0.10</sup> <sub>-0.05</sub>	60±5	0.08+0	0.22
	0.75±0.03	0.35 <sup>+0.14</sup> <sub>-0.05</sub>	60±5	0.08+0	0.22
	0.90±0.03	0.42 <sup>+0.12</sup> <sub>-0.05</sub>	60±5	0.08+0	0.22
	1.00±0.03	0.47 <sup>+0.12</sup> <sub>-0.05</sub>	60±5	0.08+0	0.22
OC-4	0.50±0.03	0.17 <sup>+0.06</sup> <sub>-0.05</sub>	90 <sup>+2</sup> <sub>-8</sub>	0.05+0	0.15
	0.60±0.03	0.20 <sup>+0.08</sup> <sub>-0.05</sub>	90 <sup>+2</sup> <sub>-8</sub>	0.05+0	0.15
	0.80±0.03	0.28 <sup>+0.10</sup> <sub>-0.03</sub>	90 <sup>+2</sup> <sub>-8</sub>	0.05+0	0.15

(4)DIMENSIONS(尺寸)

Unit:mm

NO.	CORE	Fig	A $\phi$	D
1	TH 2x2 S14	5	2.00±0.03	2.00±0.15
2	TH 2.16x3 S14	4	2.16±0.03	3.00±0.20
3	TH 2.17x1.7 S14	5	2.17±0.03	1.70±0.15
4	TH 2.2x2.5 STD	3	2.20±0.03	2.50±0.20
5	TH 2.2x2.5 S14	4	2.20±0.03	2.50±0.20
6	TH 2.35x1.5 S14	5	2.35±0.03	1.50±0.15
7	TH 2.55x2.5 STD	3	2.55±0.03	2.50±0.20
8	TH 2.6x2.8 S14	4	2.60±0.03	2.80±0.20
9	TH 2.6x2 S14	3	2.60±0.03	2.00±0.20
10	TH 2.65x4 STD	3	2.65±0.03	4.00±0.20
11	TH 3.2x2 S14	5	3.20±0.03	2.00±0.20
12	TH 3.2x5 S14	4	3.20±0.03	5.00±0.20
13	TH 3.2x5 S8	1	3.20±0.03	5.00±0.20
14	TH 3.2x5 STD	3	3.20±0.03	5.00±0.20
15	TH 3.15x15 STD	3	3.15±0.03	15.0±0.30
16	TH 3.25x3 S14	4	3.25±0.03	3.00±0.20
17	TH 3.25x3 STD	3	3.25±0.03	3.00±0.20
18	TH 3.66x8 STD	3	3.66±0.03	8.00±0.20
19	TH 3.66x8 S14	4	3.66±0.03	8.00±0.20
20	TH 3.8x12 S14	4	3.80±0.03	12.0±0.30
21	TH 3.9x5 S14	4	3.90±0.03	5.00±0.20
22	TH 3.9x5 STD	3	3.90±0.03	5.00±0.20
23	TH 3.95x8 S8	1	3.95±0.03	8.00±0.20
24	TH 4x12 STD	3	4.00±0.03	12.0±0.20
25	TH 4.32x5 S14	4	4.32±0.03	5.00±0.20
26	TH 4.5x15 S8	1	4.50±0.03	15.0±0.30
27	TH 4.6x8 S4	2	4.60±0.03	8.00±0.20
28	TH 4.6x8 S14	4	4.60±0.03	8.00±0.20
29	TH 6x9 STD	3	6.00±0.03	9.00±0.20
30	TH 6x15 S4	2	6.00±0.03	15.0±0.30
31	TH 6x25 S4	2	6.00±0.03	25.0±0.40
32	TH 6.2x9 STD	3	6.20±0.03	9.00±0.20
33	TH 8x20 S4	2	8.00±0.03	20.0±0.40